

12/20/2005 x:\Projects\6041\DCAD\INDVLOTS\Lot_77

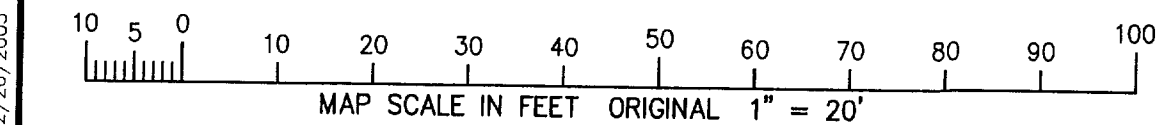

2007-2347

ZSR-77

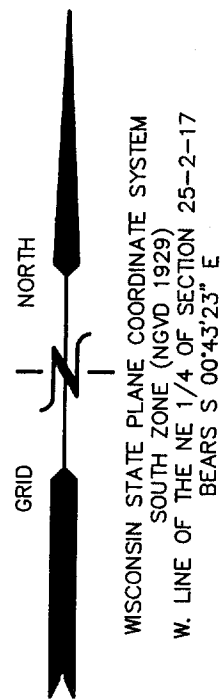

PLAT OF SURVEY

LOT 77 OF STONE RIDGE, A SUBDIVISION

LOCATED IN PART OF THE SE 1/4 OF THE SW 1/4 & SW 1/4 AND SE 1/4 OF THE SE 1/4 OF SECTION 24 AND IN PART OF THE NE 1/4 AND NW 1/4 OF THE NW 1/4 & NE 1/4, NW 1/4, SW 1/4, AND SE 1/4 OF THE NE 1/4 OF SECTION 25, ALL IN TOWN 2 NORTH, RANGE 17 EAST, CITY OF LAKE GENEVA, WALWORTH COUNTY, WISCONSIN

CENTER STREET
66' WIDE R.O.W.

SETTLERS RIDGE DRIVE
60' WIDE PUBLIC R.O.W.

EXISTING SANITARY SEWER

EXISTING WATERMAIN

R=630.00'
98.95'
C=98.84'
N 84° 56' 49" E

LINE	BEARING	DISTANCE
L1	N 89° 26' 47" E	5.87

LOT 77
21,743 S.F.

LOT 78

NOTE: NO EVIDENCE OF UTILITIES SUCH AS TELEPHONE, ELECTRIC, GAS, ETC. PRESENT AS OF DATE OF SURVEY. USERS SHOULD CONFIRM THESE SERVICES ARE AVAILABLE.

12' WIDE UTILITY EASEMENT
CENTERED ON LOT LINES

- LEGEND
- = IRON REBAR STAKE
 - {XXX} = RECORDED AS
 - ⊗ = EXISTING WATER VALVE
 - ⊕ = EXISTING HYDRANT W/ VALVE

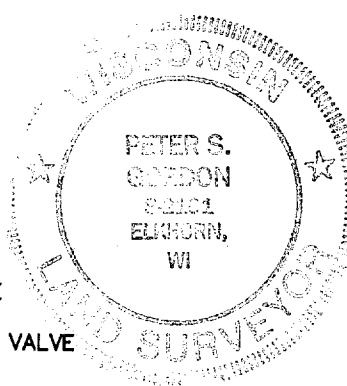

NOTE: COPIES OF THIS MAP TO WHICH THE FOLLOWING CERTIFICATE WILL APPLY SHOW SURVEYOR'S ORIGINAL SEAL AND SIGNATURE IN BLACK INK. COPIES BY ANY OTHER MEANS MAY HAVE ALTERATIONS WHICH DO NOT REPRESENT THE SURVEYOR'S WORK PRODUCT.

I HEREBY CERTIFY THAT THE ABOVE DESCRIBED PROPERTY HAS BEEN SURVEYED UNDER MY DIRECTION AND THAT THE ABOVE MAP IS A TRUE REPRESENTATION THEREOF AND SHOWS THE SIZE AND LOCATION OF THE PROPERTY, ITS EXTERIOR BOUNDARIES, THE LOCATION OF ALL VISIBLE STRUCTURES, AND DIMENSIONS OF ALL PRINCIPLE BUILDINGS THEREON, BOUNDARY FENCES, APPARENT EASEMENTS, ROADWAYS, AND VISIBLE ENCROACHMENTS, IF ANY. THIS SURVEY IS MADE FOR THE USE OF THE PRESENT OWNERS OF THE PROPERTY, AND ALSO THOSE WHO PURCHASE, MORTGAGE, OR GUARANTEE THE TITLE THERETO WITHIN ONE YEAR FROM THE DATE HEREOF.

DATED: NOVEMBER 28, 2005

Peter S. Gordon
PETER S. GORDON R.L.S. 2101

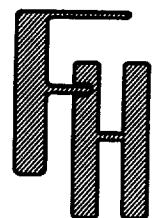

PLAT OF SURVEY

WORK ORDERED BY -
FAIRWYN, LTD.
851 PARK DRIVE SUITE 104
LAKE GENEVA, WI 53147

FARRIS, HANSEN & ASSOCIATES, INC.
ENGINEERING - ARCHITECTURE - SURVEYING
7 RIDGWAY COURT P.O. BOX 437
ELKHORN, WISCONSIN 53121
OFFICE: (262) 723-2098 FAX: (262) 723-5886

REVISIONS

PROJECT NO.
6041.77
DATE:
11/28/2005
SHEET NO.
1 OF 1

007-2347